



# MMRS

---

MULTI MOD RACK SYSTEM

# MMRS

## MULTI MOD RACK SYSTEM

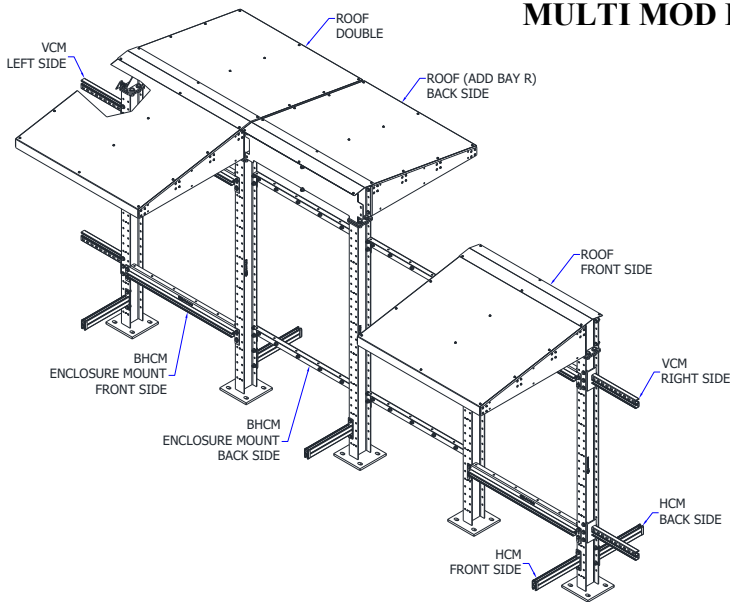

### Applications

Suitable for application in many industries including Oil & Gas, Industrial, Offshore, Power, Marine, Petrochemical and Chemical.

Ideal for Control Stations, Motor Starters, Junction Boxes, Circuit Breakers, Disconnects, Receptacles, Distribution and Transformers.

### Product Details and Benefits

MMRS was developed to fulfill an increasing need for a modular field erectable rack system that requires minimal labor skill sets to assemble and no field welding. MMRS provides for mounting of various equipment types on front and/or back side of the rack. A system can be configured with or without roofs.

MMRS has been independently "Third Party" PE reviewed for compliance to the wind load requirements of ASCE 7-22 including wind load in CFR 193 Part 193.2067 for LNG facilities.

- System can be configured with any mixture of 24" / 36" / 48" bays. (Ex: 4 Bay 36" / 24" / 48" / 48")
- Can be flat packed / tagged and ship to site.
- Field erectable with minimal labor skill sets.
- No field welding required.
- Each Bay can be provisioned with BHCM's on front and/or back sides independent of each other for equipment mounting. BHCM's are slotted to provide infinite adjustability throughout the vertical column length for all equipment mounting dimensions. BHCM's are fitted with 1 5/8" x 1 5/8" strut which provides infinite horizontal equipment mounting dimensions.
- Load bearing structural components are Carbon Steel 50ksi minimum. H.D.G.A.F. (Hot Dip Galvanize After Fabrication)
- Load bearing structural fasteners are B7 or equivalent 105ksi. with a Fluoropolymer coating. (IE: Trade Names Xylan / Fluorokote#1)

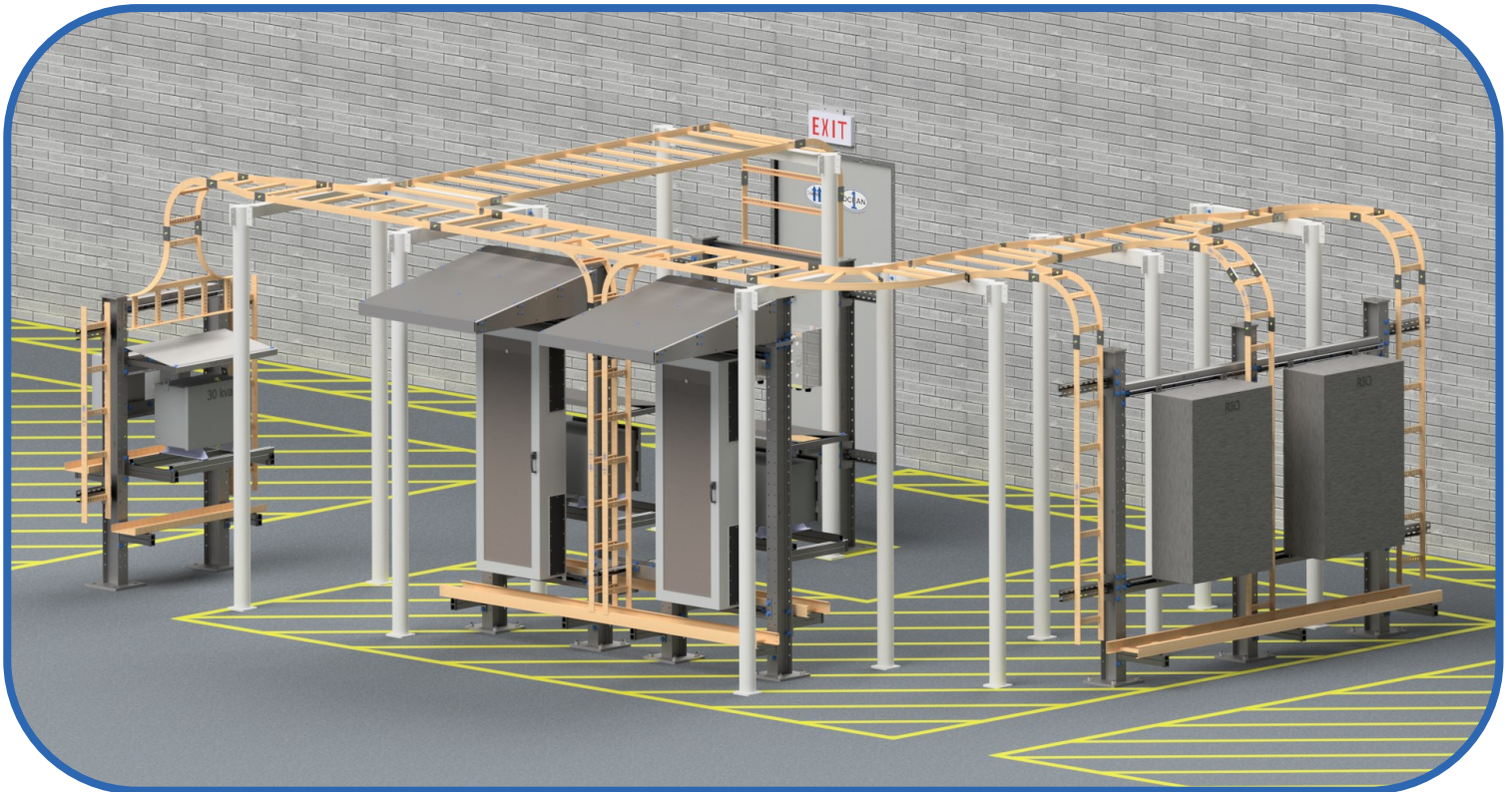

## MAIN COMPONENTS

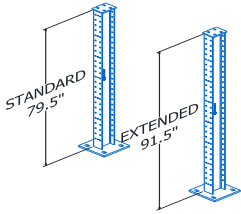

### **BC (Bay Column / Upright) <sup>1</sup>**

- Available in Standard and Extended heights..
- W-Beam is welded to the bottom Base Plate and the top Roof Mount.
- W-Beam flange is perforated on both sides of web with 9/16" holes on 3" centers.
- Single BC can be utilized as a stanchion to mount various types of transmitters / monitors and more.
- Contact manufacturer for special height requirements.

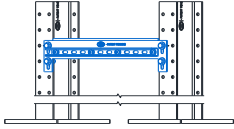

### **BHCM (Bay Horizontal Cross-Member) <sup>1,2</sup>**

- Mount enclosures, panels and other items on 24", 36" or 48" Bay widths.
- BHCM's are slotted to provide infinite adjustability throughout the column length for all equipment mounting dimensions.
- Strut is 1 5/8" x 1 5/8" bolted to BHCM providing for change out of damaged or material type if needed.

## ADD-ONS / ACCESSORIES

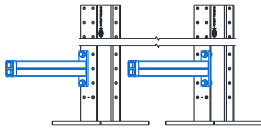

### **HCM (Horizontal Cantilever Mount) <sup>1,2</sup>**

- Mount cable tray, conduit, pipe and other items in a flat horizontal position.
- Available in 2" increments from 12" to 26".
- Back to Back strut provides for mounting on top and/or bottom.

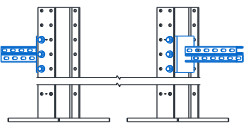

### **VCM (Vertical Cantilever Mount) <sup>1,2</sup>**

- Mount cable tray, conduit, pipe and other items in a vertical position.
- Available in 2" increments from 12" to 26".
- Double Combination strut provides for mounting on front side and/or back side of VCM.

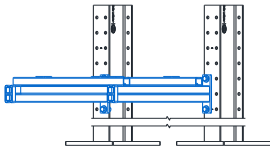

### **TMK (Transformer Mount Kit) <sup>1,2</sup>**

- Bay widths 24/36/48 can be configured for 15kva, 30kva, 45kva or other sizes as required.
- 15kva can be wall mounted using two BHCM's.
- Capable of 650 lb. load. Contact manufacturer for additional load requirements.
- TMK adjustability provides for additional configurations to accommodate other foot mounted equipment.

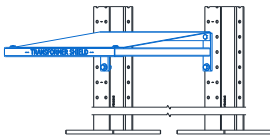

### **TCS (Transformer Cover Shield) <sup>1,2</sup>**

- TCS is a light weight alternative of a full roof.
- Bay widths 24/36/48 can be configured to shield 15kva, 30kva, 45kva or other equipment.
- TCS's outward extension length are in three lengths to minimize protrusion into the work area. This allows for placement below head height.

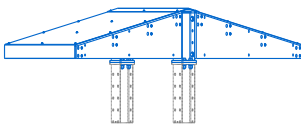

### **RF (Roof - Single / Double) <sup>1,2</sup>**

- Roof configurations can be front, back or double front and back.
- Multi Bay configurations use the "Add a Bay" Roofs.
- Underneath cross member purlins are perforated 13/32" dia. on 8" centers providing a mount for slotted strut or other mount types to facilitate lights, alarms, monitors, etc..

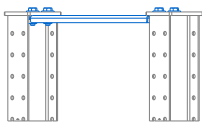

### **CCP (Column Connector Plate) <sup>1,2</sup>**

- CCP is required when a VCM is attached to a BC.
- The requirement is to minimize the reaction torsion moment of the VCM being applied to the BC.

FOOTNOTES: 1. Components are H.D.G.A.F. 2. Required fastener kits included.

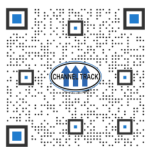

MMRS  
Data Sheets

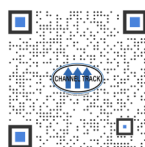

MMRS Brochure  
Digital Download

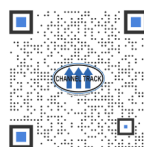

Configurator  
Request Form

Manufacturer's Brochures

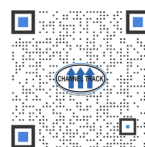

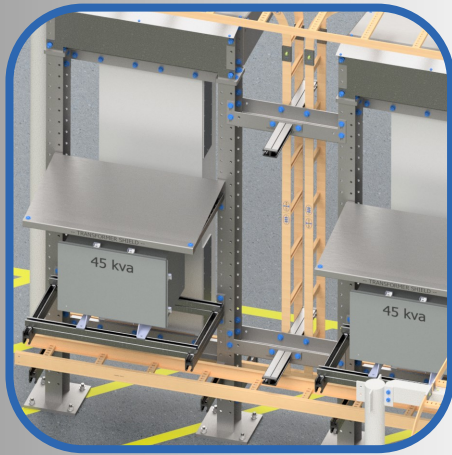

# MMRS

## MULTI MOD RACK SYSTEM

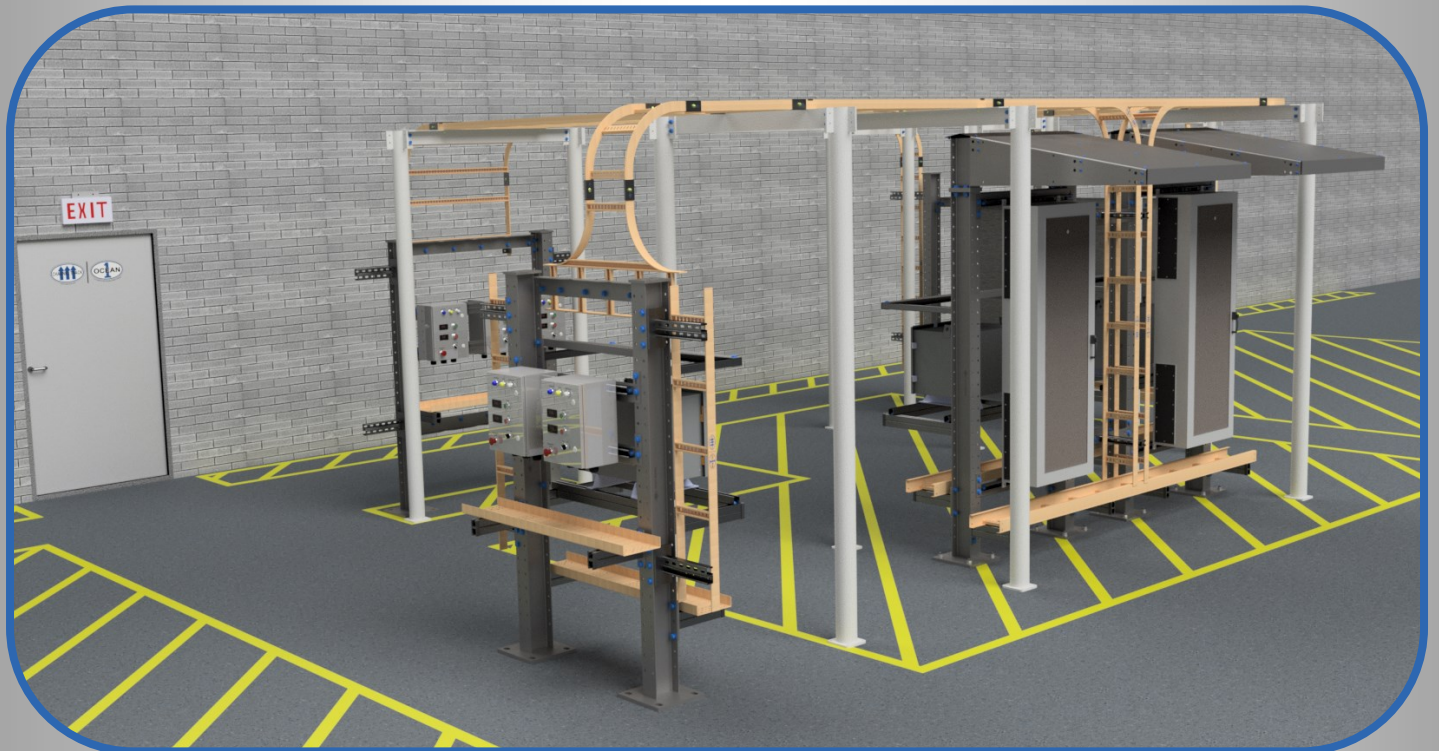
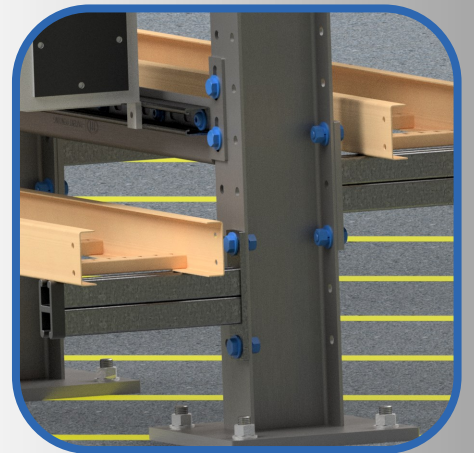
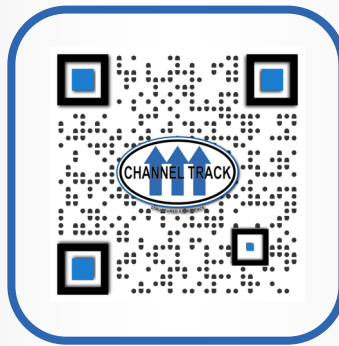

11750 CLAY RD.  
HOUSTON, TEXAS 77043 USA

PH. 713-864-2551  
[www.Channel-Track.com](http://www.Channel-Track.com)